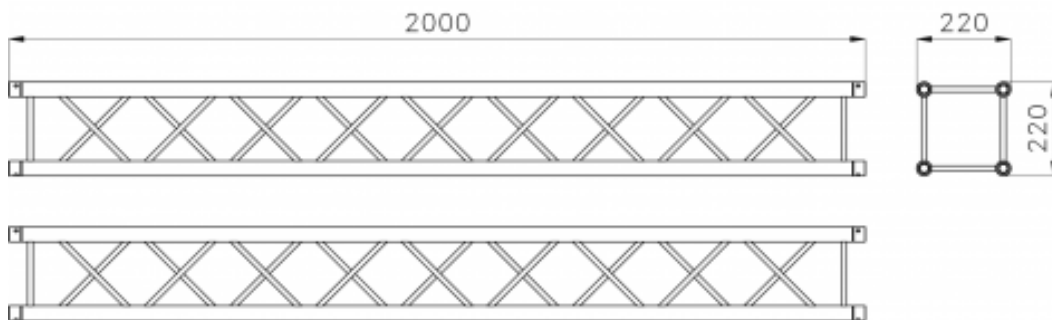
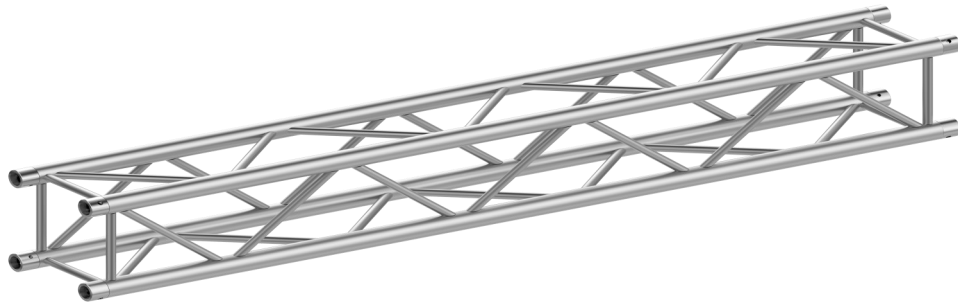

B22Q

Square truss 22cm side, bushing connection for conical spigots

Traliccio quadro sezione 22cm, connessione a boccia per giunto conico

STRAIGHTS - LINEARI [Kg]

B22Q 050	L= 50cm	3,5
B22Q 100	L= 100cm	5,1
B22Q 150	L= 150cm	6,7
B22Q 200	L= 200cm	8,3
B22Q 250	L= 250cm	10,0
B22Q 300	L= 300cm	11,6
B22Q 350	L= 350cm	13,4
B22Q 400	L= 400cm	15,0
BQ2 KS	(coupling set)	0,6

CORNERS - ANGOLI [Kg]

B22Q 2L90	2V 90°	4,8
B22Q 3L	3V 90°	5,9
B22Q 3T	3V 90° - T	4,5
B22Q 4T	4V 90° - T	6,5

SPAN - CAMPATA

Lenght	UDL	CPL	Defl.
[m]	[kg/m]	[kg]	[cm]
3	147	221	0,48
4	80	161	0,86
5	49	122	1,32
6	32	98	1,91
7	22	79	2,60
8	18	65	3,77
9	11	53	4,36
10	8	43	5,35

Main Tubes - Tubi Correnti: EN AW-6060 T6 Ø35x2mm
Diagonals - Diagonali: EN AW-6060 T6 Ø12x1,5mm
Bushings - Boccole: EN AW-6082 T6
Coupling Set - Set di connessione:



UDL, Uniformly Distributed Load - CPL, Centred Point Load - Defl., Deflection

