

# B22Q

Square truss 22cm side, bushing connection for conical spigots

Traliccio quadro sezione 22cm, connessione a boccola per giunto conico

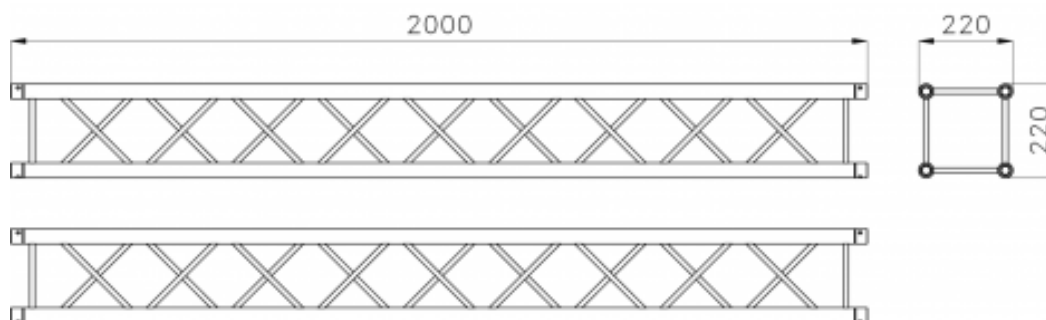
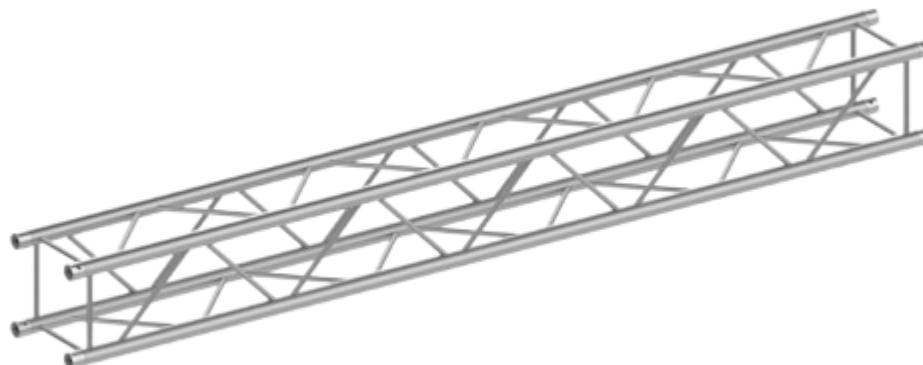

## STRAIGHTS - LINEARI [Kg]

B22Q 050	L= 50cm	2,0
B22Q 100	L= 100cm	3,3
B22Q 150	L= 150cm	4,7
B22Q2 00	L= 200cm	6,2
B22Q 250	L= 250cm	7,6
B22Q 300	L= 300cm	8,9
B22Q 350	L= 350cm	10,4
B22Q 400	L= 400cm	11,8
BQ2 KS	(coupling set)	0,6

## SPAN - CAMPATA

Lenght	UDL	CPL	Defl.
[m]	[kg/m]	[kg]	[cm]
3	147	221	0,48
4	80	161	0,86
5	49	122	1,32
6	32	98	1,91
7	22	79	2,60
8	18	65	3,77
9	11	53	4,36
10	8	43	5,35

Main Tubes - Tubi Correnti: EN AW-6060 T6  $\varnothing$ 35x2mm  
 Diagonals - Diagonali: EN AW-6060 T6  $\varnothing$ 12x1,5mm  
 Bushings - Boccole: EN AW-6082 T6  
 Coupling Set - Set di connessione:



UDL, Uniformly Distributed Load - CPL, Centred Point Load - Defl., Deflection



# B22Q

Square truss 22cm side, bushing connection for conical spigots

Traliccio quadro sezione 22cm, connessione a boccia per

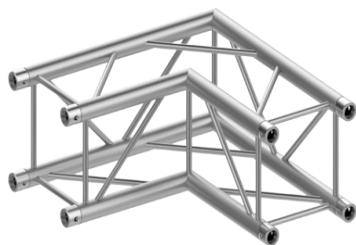

B22Q 2L90

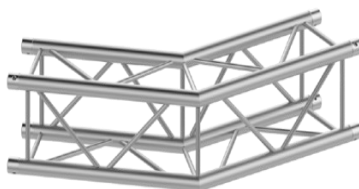

B22Q 2L135

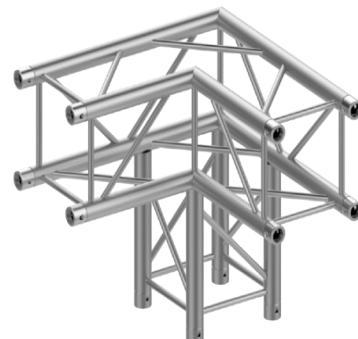

B22Q 3L

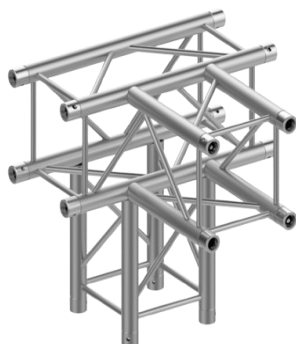

B22Q 4T



B22Q 4X

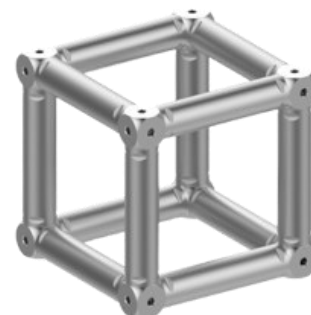

C22Q 8

CORNERS - ANGOLI		[Kg]	[cm]	[cm]	[cm]
B22Q 2L90	2V 90°	2,7	50	50	22
B22Q 2L135	3V 90°	3,6	50	50	22
B22Q 3L	3V 90° L	3,7	50	50	50
B22Q 4T	4V 90° - T	4,0	50	50	50
B22Q 4X	4V 90° - X	3,5	50	50	22
C22Q 8	CUBO	2,9	22	22	22



Coupling Set base- Set di connessione base

# B22T

Triangular truss 22cm side, bushing connection for conical spigots

Traliccio triangolare sezione 22cm, connessione a boccia per giunto conico

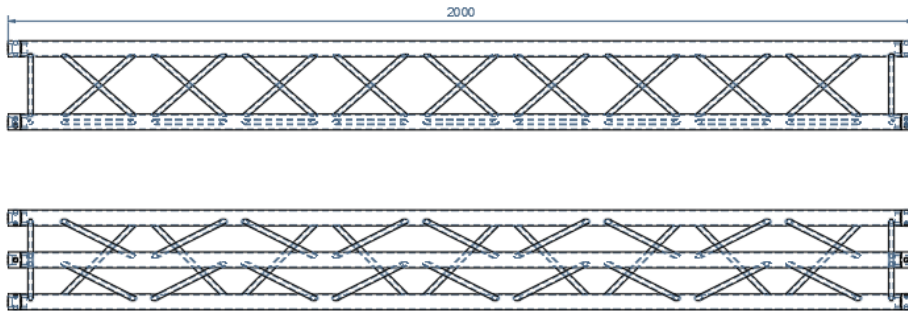
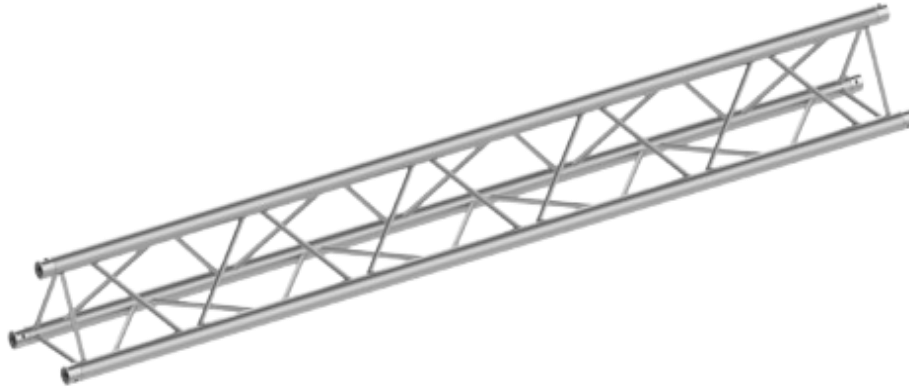

## STRAIGHTS - LINEARI [Kg]

B22T 050	L= 50cm	1,5
B22T 100	L= 100cm	2,5
B22T 150	L= 150cm	3,5
B22T 200	L= 200cm	4,6
B22T 250	L= 250cm	5,7
B22T 300	L= 300cm	6,7
B22T 350	L= 350cm	7,8
B22T 400	L= 400cm	8,8
BT2 KS	(coupling set)	0,5

## CORNERS - ANGOLI [Kg]

## SPAN - CAMPATA

Lenght	UDL	CPL	Defl.
[m]	[kg/m]	[kg]	[cm]
4	47	95	1,9
5	30	74	2,9
6	20	60	4,1
7	14	50	5,7
8	11	42	7,9
9	8	36	9,4
10	6	31	11,7

Main Tubes - Tubi Correnti: EN AW-6060 T6  $\varnothing$ 35x2mm

Diagonals - Diagonali: EN AW-6060 T6  $\varnothing$ 12x1,5mm

Bushings - Boccole: EN AW-6082 T6

Coupling Set - Set di connessione:



UDL, Uniformly Distributed Load - CPL, Centred Point Load - Defl., Deflection



# B22T

Triangular truss 22cm side, bushing connection for conical spigots

Traliccio triangolare sezione 22cm, connessione a boccia per giunto conico



B22T 2L90



B22Q 2L90I

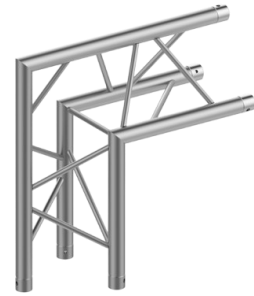

B22Q 2L90E

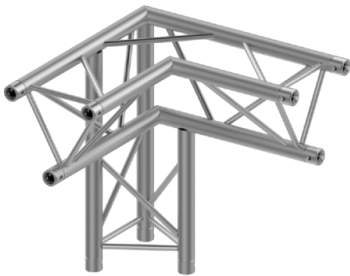

B22T 3L90LR

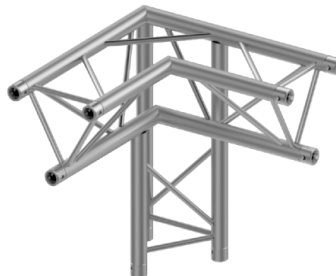

B22T 3L90LL

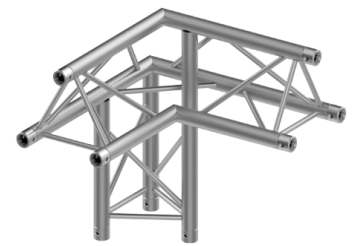

B22T 3L90R



B22T 3L90L

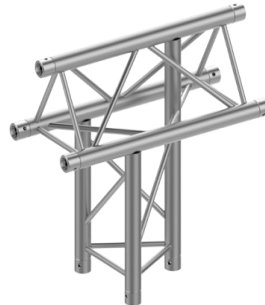

B22T 3TL

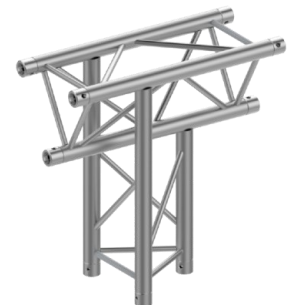

B22T 3LT

CORNERS - ANGOLI		[Kg]	[cm]	[cm]	[cm]
B22T 2L90	2V 90°	1,8	22	50	50
B22T 2L90I	2V 90° INT	2,2	22	50	50
B22T 2L90E	2V 90° EST	1,8	22	50	50
B22T 3L90LR	3V DX V/B	3,1	50	50	50
B22T 3L90LL	3V SX V/B	3,1	50	50	50
B22T 3L90R	3V DX V/A	2,9	50	50	50
B22T 3L90L	3V SX V/A	2,9	50	50	50
B22T 3TL	3V 90°-T V/A	2,4	50	22	50
B22T 3LT	3V 90°-T V/B	2,4	50	22	50
B22T 3T	3V 90°-T V/AB	2,4	50	50	22



B22T 3T

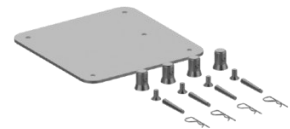

Coupling Set base- Set di connessione base

# B22L

Flat truss 22cm side, bushing connection for conical spigots

Traliccio piano sezione 22cm, connessione a boccola per giunto conico

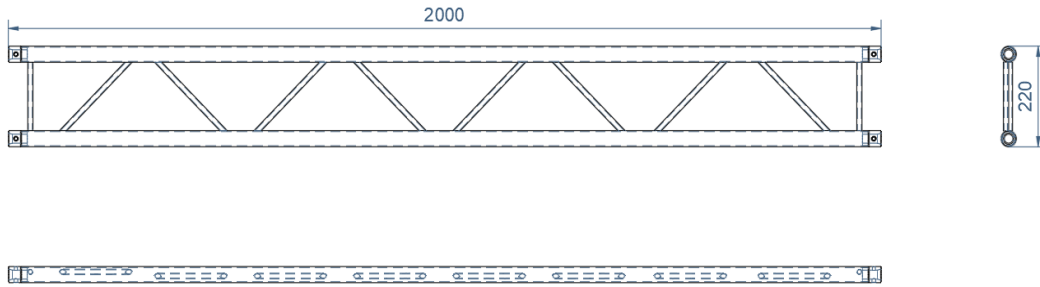
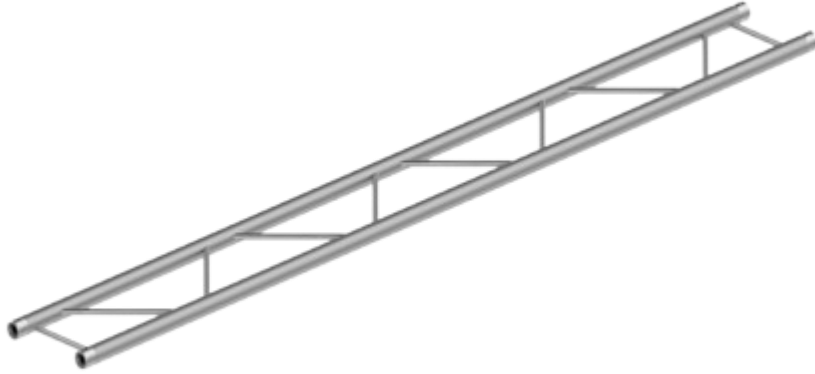

STRAIGHTS - LINEARI		[Kg]
B22L 050	L= 50cm	1
B22L 100	L= 100cm	1,5
B22L 150	L= 150cm	2,2
B22L 200	L= 200cm	2,9
B22L 250	L= 250cm	3,5
B22L 300	L= 300cm	4,1
B22L 350	L= 350cm	4,7
B22L 400	L= 400cm	5,3
BL2 KS	(coupling set)	0,3

## SPAN - CAMPATA

Lenght	UDL	CPL	Defl.
[m]	[kg/m]	[kg]	[cm]
2	88	88	0,11
3	36	54	0,26
4	17	35	0,46
5	9	23	0,86
6	4	14	1,04

Main Tubes - Tubi Correnti: EN AW-6060 T6  $\varnothing$ 35x2mm  
 Diagonals - Diagonali: EN AW-6060 T6  $\varnothing$ 12x1,5mm  
 Bushings - Boccole: EN AW-6082 T6  
 Coupling Set - Set di connessione:



UDL, Uniformly Distributed Load - CPL, Centred Point Load - Defl., Deflection



# B22T

Triangular truss 22cm side, bushing connection for conical spigots

Traliccio triangolare sezione 22cm, connessione a boccia per giunto conico



B22L 3LPL

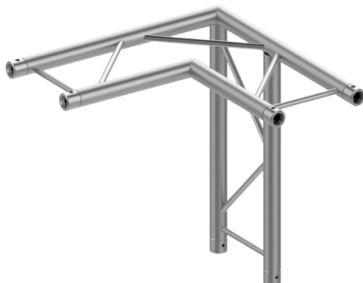

B22L 3LPR

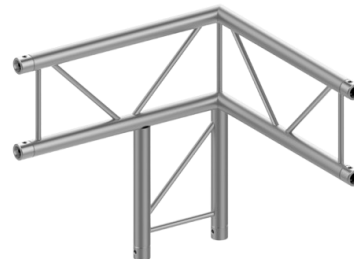

B22L 3LVL

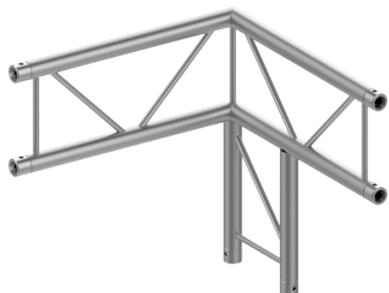

B22L 3LVR

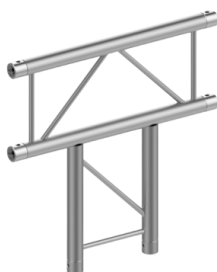

B22L 3TP

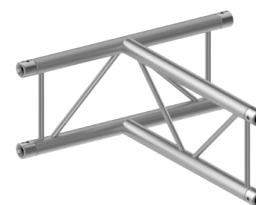

B22L 3TV



B22L 4TV

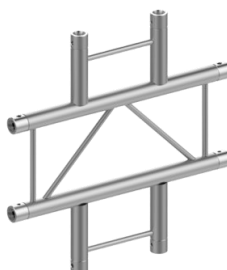

B22L 4XP

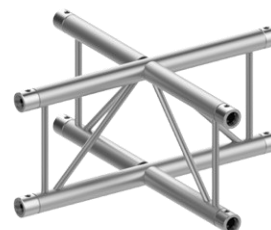

B22L 4XV

CORNERS - ANGOLI		[Kg]	[cm]	[cm]	[cm]
B22L 3LPL	3V 90° DX O	2,0	50	50	50
B22L 3LPR	3V 90° SX O	2,0	50	50	50
B22L 3LVL	3V 90° SX V	2,0	50	50	50
B22L 3LVR	3V 90° DX V	2,0	50	50	50
B22L 3TP	3V-T O	1,5	50	3,5	50
B22L 3TV	3V-T V	1,5	50	50	22
B22L 4TV	4V-T V	2,1	50	50	50
B22L 4XP	4V-X O	1,5	50	3,5	50
B22L 4XV	4V-X V	2,0	50	50	22